

# Johns Creek Walk

11030 Medlock Bridge Road  
Johns Creek, GA 30097

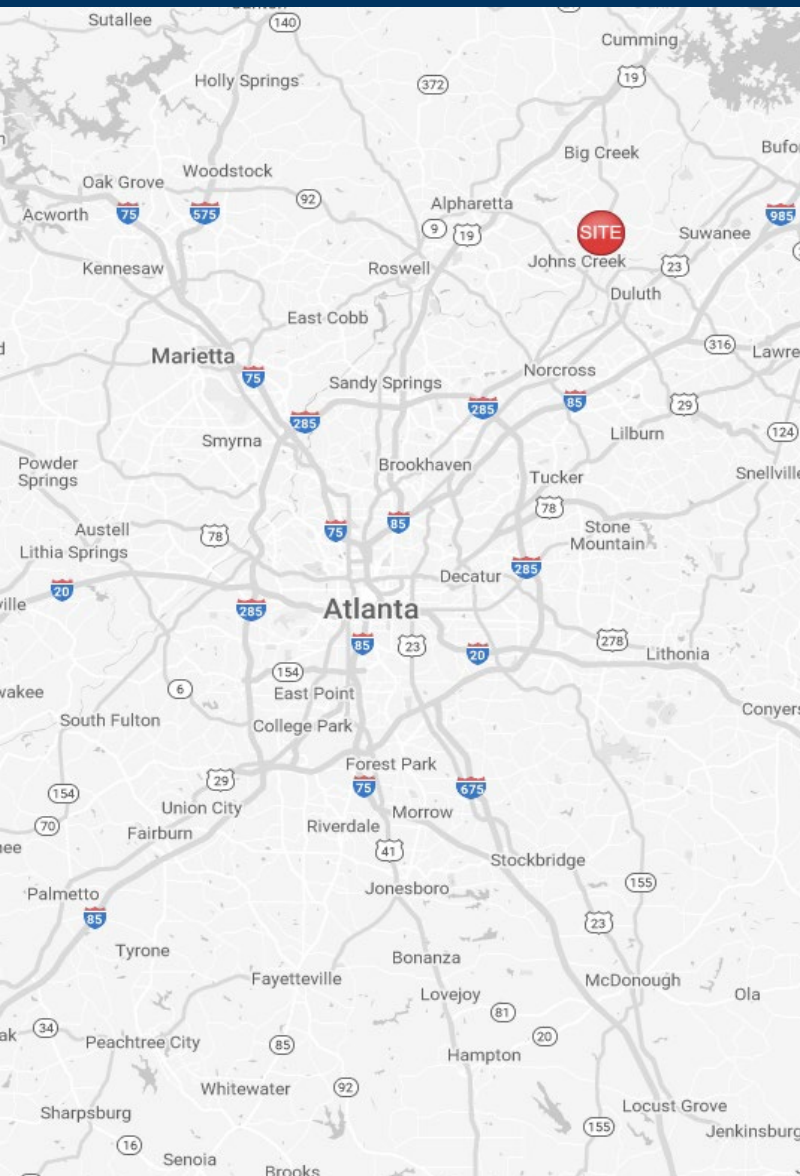

RIVERWOOD  
PROPERTIES, LLC

## Leasing Contacts

Marrissa Chanin  
678-501-5341  
Marrissa@riverwoodproperties.com

Allie Hodge  
678-501-5342  
ahodge@riverwoodproperties.com

[riverwoodproperties.com](http://riverwoodproperties.com)

## Property Highlights

- Johns Creek Walk is located on Medlock Bridge Road (GA 141) with daily traffic counts over 41,000 vehicles.
- Johns Creek Walk consists of multi-family units, a senior living community, private residences, senior living apartments, and professional offices/retail.
- The retail shopping center is conveniently located near Johns Creek Parkway which is the home of several Fortune 500 companies within the Technology Park business district.
- Retail Spaces Available | 1,400-1,750 SF

**Site Access:** Property is accessible via two curb cuts on Medlock Bridge Road.



# John's Creek Walk

## TENANTS

10-20	Francis Fong Martial Arts	4,200
30	The Parlor Beauty	1,400
40	HCG Weight Loss Atlanta	1,400
50	Shwarma Press	1,400
60	Retail Space Available	1,750
70	Coldwell Banker	5,007
110	Another Broken Egg	5,500
120	F45	3,212
130	Herbal Plant & Wellness	1,000
140	Retail Space Available	1,400
150	Sushi Mio	1,400
160	Maverick's Mexican Cantina	2,800
210	Johnny's Pizza	3,575
230	100 Percent Chiropractic	1,755
240	Woo Chon	1,300
250	Beauty Skin Laser	1,300
260	Studio 108	1,820
270	Pearl's Tea	1,400
280	Dry Cleaners	1,500
GLA: 24,400 SF		
Availability:		1,300 - 1,750 SF

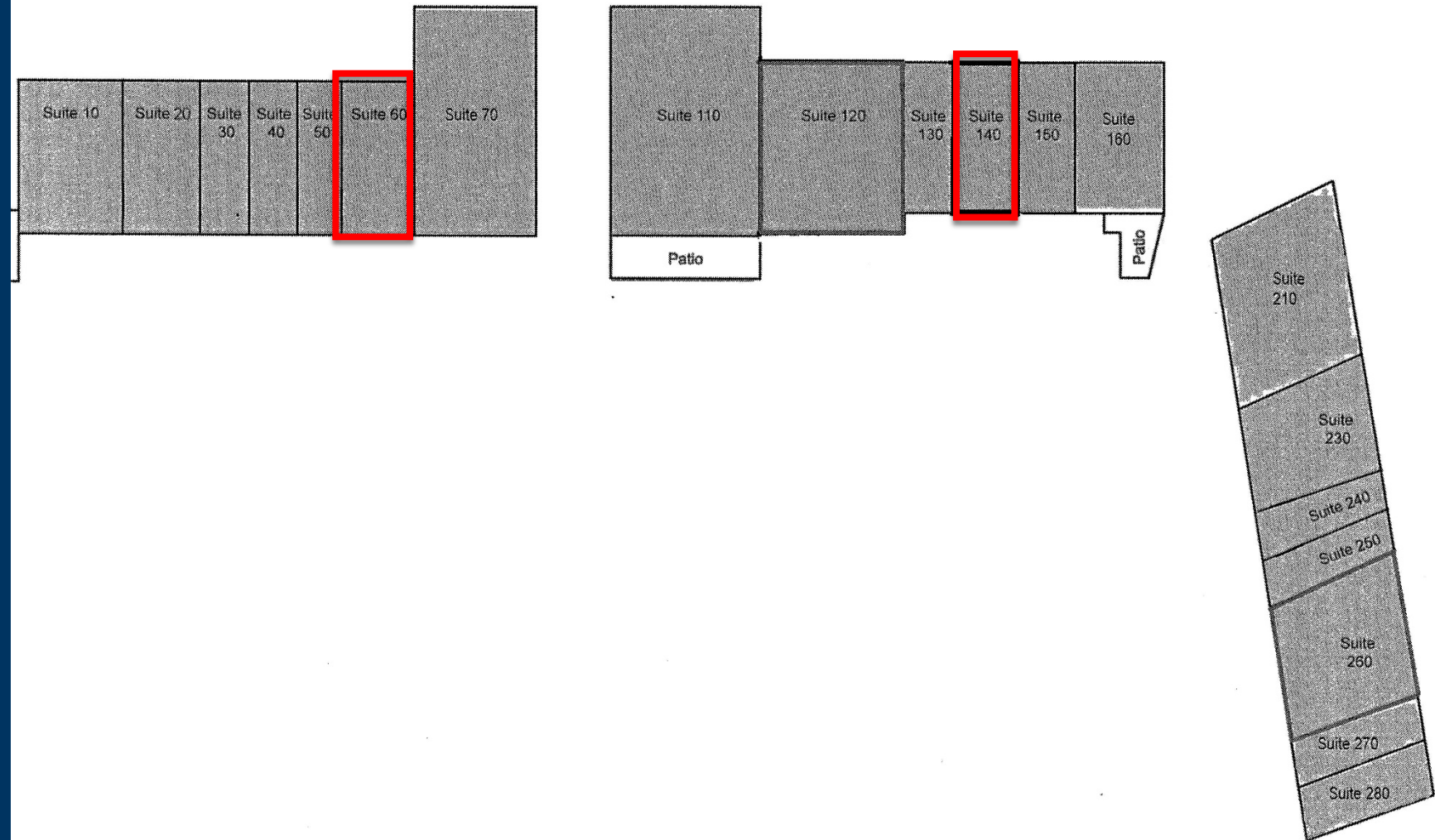

**JOHN'S CREEK WALK**  
*Site Plan*



# AREA DEMOGRAPHICS



2022  
Population

1 MILE	9,923
3 MILE	81,302
5 MILE	195,277



2022 Daytime  
Population

1 MILE	6,747
3 MILE	36,520
5 MILE	98,247



Household 2022

1 MILE	3,372
3 MILE	27,178
5 MILE	66,161



Household  
Income

1 MILE	\$135,034
3 MILE	\$161,390
5 MILE	\$167,049



## JOHN'S CREEK WALK

Trade Area Overview