

# Johns Creek Walk

11030 Medlock Bridge Road  
Johns Creek, GA 30097

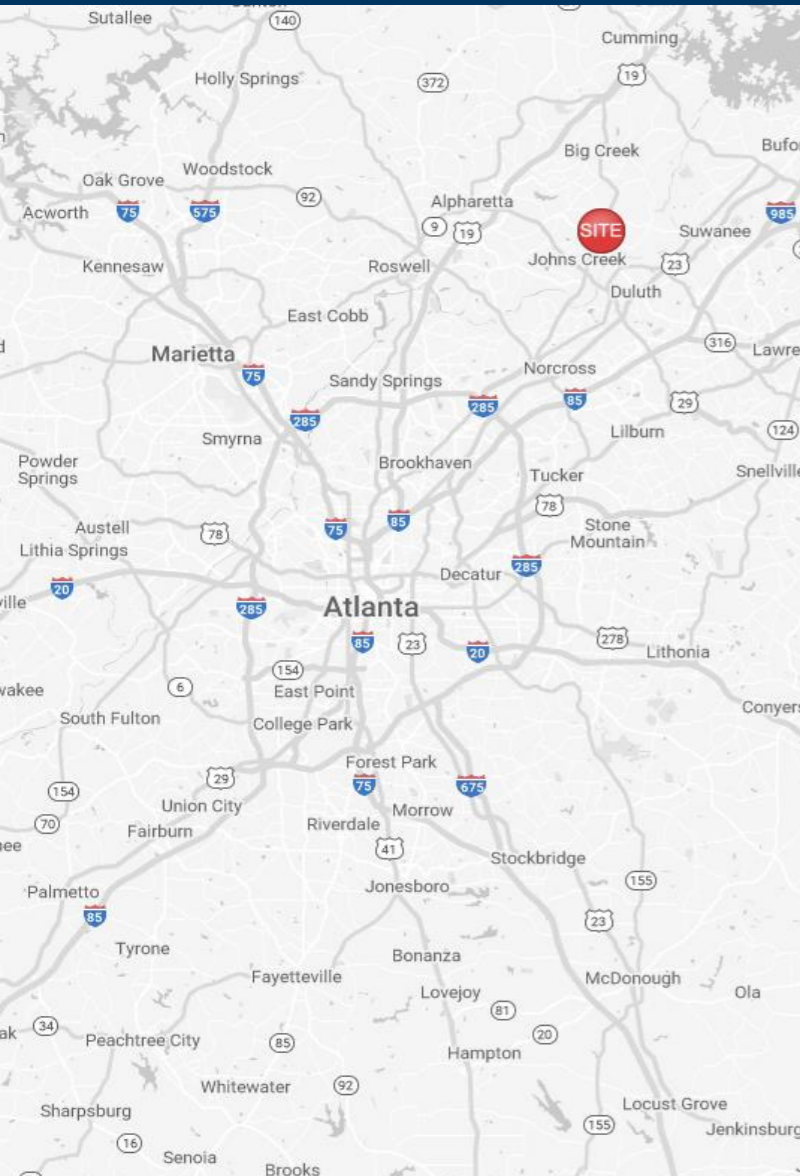

RIVERWOOD  
PROPERTIES, LLC

## Leasing Contacts

Allie Hodge Motz  
678-501-5342  
allie@riverwoodproperties.com

## Property Highlights

- Johns Creek Walk is located on Medlock Bridge Road (GA 141) with daily traffic counts over 41,000 vehicles.
- Johns Creek Walk consists of multi-family units, a senior living community, private residences, senior living apartments, and professional offices/retail.
- The retail shopping center is conveniently located near Johns Creek Parkway which is the home of several Fortune 500 companies within the Technology Park business district.
- Retail Spaces Available | 1,000-3,575 SF
- Zoned C4-Commerical Small Tracts



# Johns Creek Walk

## TENANTS

10-20	Francis Fong Martial Arts	4,200
30	The Parlor Beauty	1,400
40	Retail Space Available	1,400
50	Shwarma Press	1,400
60	W.E. Music Academy	1,750
70	Coldwell Banker	5,007
110	Another Broken Egg	5,500
120	F45	3,212
130	Retail Space Available	1,000
140	Retail Space Available	1,400
150	Throom Thai and Sushi	1,400
160	Maverick's Mexican Cantina	2,800
210	Restaurant Space Available	3,575
230	100 Percent Chiropractic	1,755
240	Papa's Dumpling	1,300
250	Beauty Skin Laser	1,300
260	Studio 108	1,820
270	Pearl's Tea	1,400
280	Dry Cleaners	1,500
GLA:		43,119
Availability:		1,000 - 3,575 SF

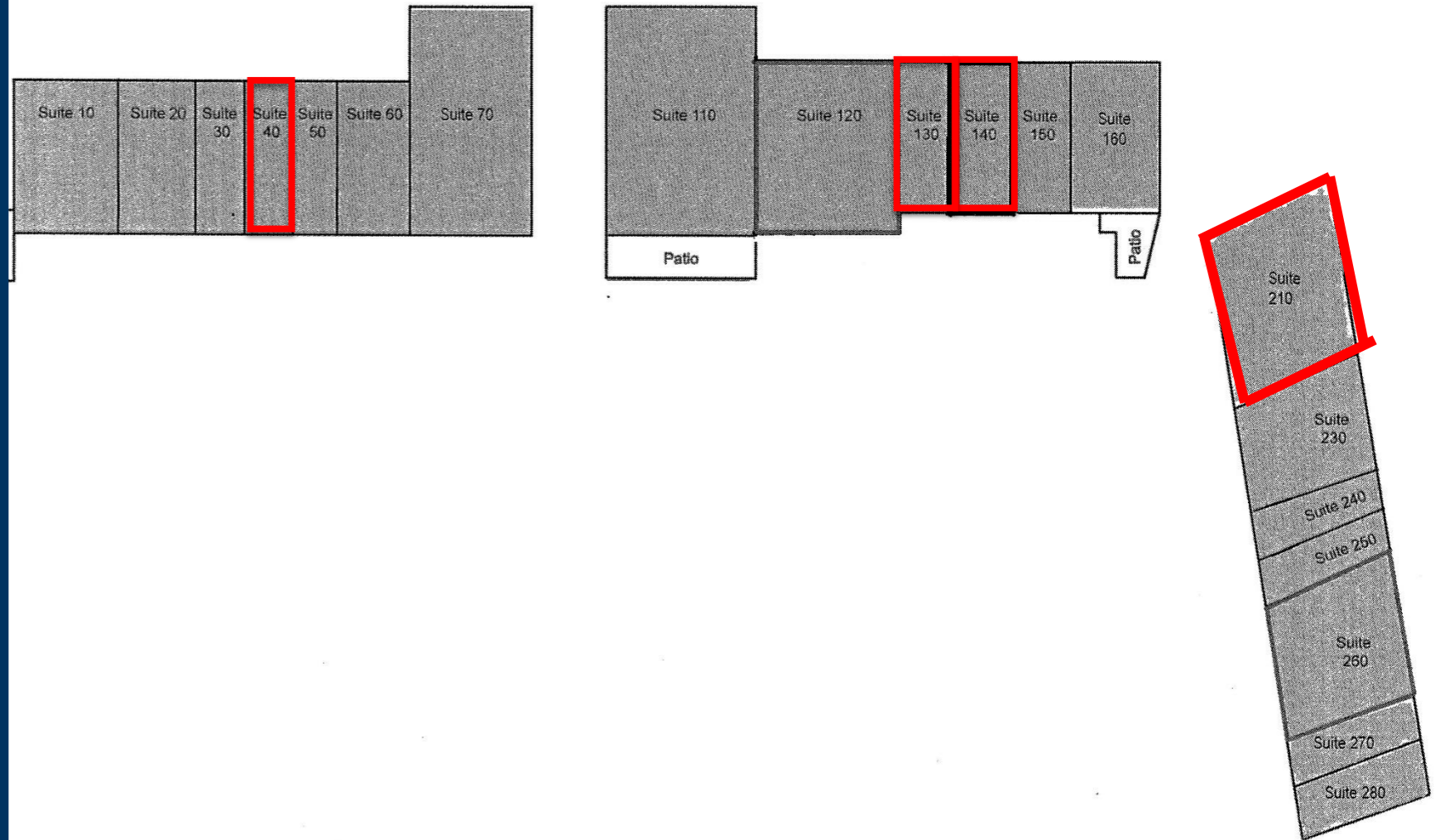

**JOHNS CREEK WALK**  
*Site Plan*



# AREA DEMOGRAPHICS



2023  
Population

1 MILE	9,565
3 MILE	78,351
5 MILE	187,457



2023 Daytime  
Population

1 MILE	5,696
3 MILE	35,451
5 MILE	96,046



Household 2023

1 MILE	3,281
3 MILE	25,790
5 MILE	63,216



Household  
Income

1 MILE	\$173,683
3 MILE	\$206,261
5 MILE	\$213,838



## JOHNS CREEK WALK

Trade Area Overview