

# Caliber Point

3245 Cobb Pkwy NW  
Kennesaw, Georgia 30101



## Leasing Contacts

Marrissa Chanin  
678-501-5341  
marrissa@riverwoodproperties.com

Allie Hodge  
678-501-5342  
allie@riverwoodproperties.com

[riverwoodproperties.com](http://riverwoodproperties.com)

## Property Highlights

- Caliber Point is an unanchored center located on Cobb Pkwy NW
- Located near the intersection of Cobb Pkwy NW and Acworth Due West Rd in Kennesaw, Georgia
- Multiple access points with one on Cobb Pkwy NW and the other on Acworth Due West Rd
- Boasts a strong mix of service, retail and restaurant tenants
- Over 33,000 VPD
- Grease Trap Available
- Retail Space Available | 2,400 SF

**Site Access:** Site is accessible via Cobb Pkwy or Acworth Due West Rd NW

# Caliber Point TENANTS

101	Aspen Dental	4,000 SF
105	Retail Space Available	2,400 SF
113	AT&T	5,020 SF
	GLA	11,420
	Availability:	2,400 SF Available for Lease

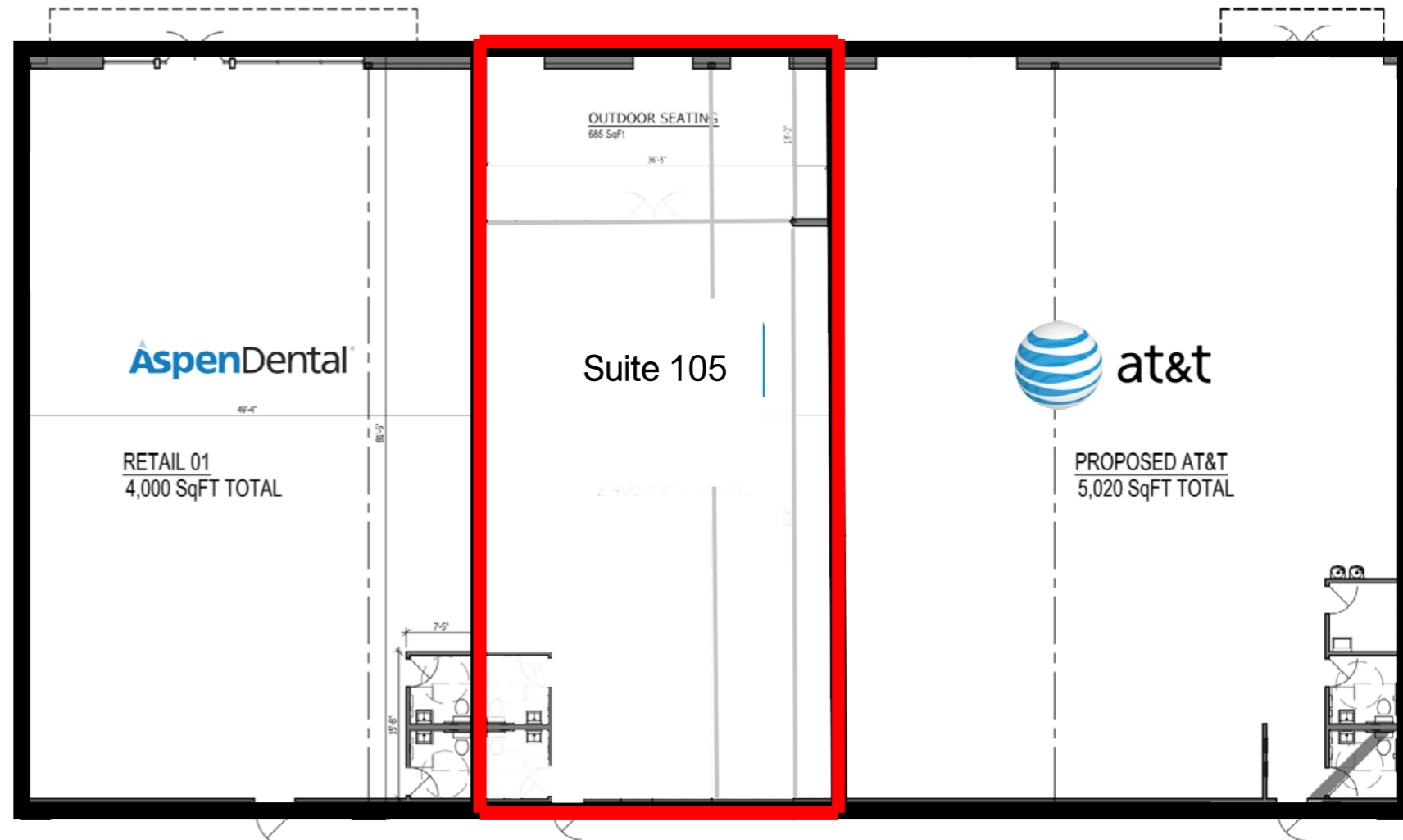

# AREA DEMOGRAPHICS



2023  
Population

1 MILE	7,120
3 MILE	54,650
5 MILE	140,562



2023 Daytime  
Population

1 MILE	2,968
3 MILE	14,611
5 MILE	41,333



Household 2023

1 MILE	2,526
3 MILE	19,617
5 MILE	49,262



Household  
Income

1 MILE	\$96,719
3 MILE	\$125,609
5 MILE	\$136,681



## CALIBER POINT

Trade Area Overview