

Cedarcrest Corner

8465 Dallas Acworth Highway
Dallas, Georgia 30132

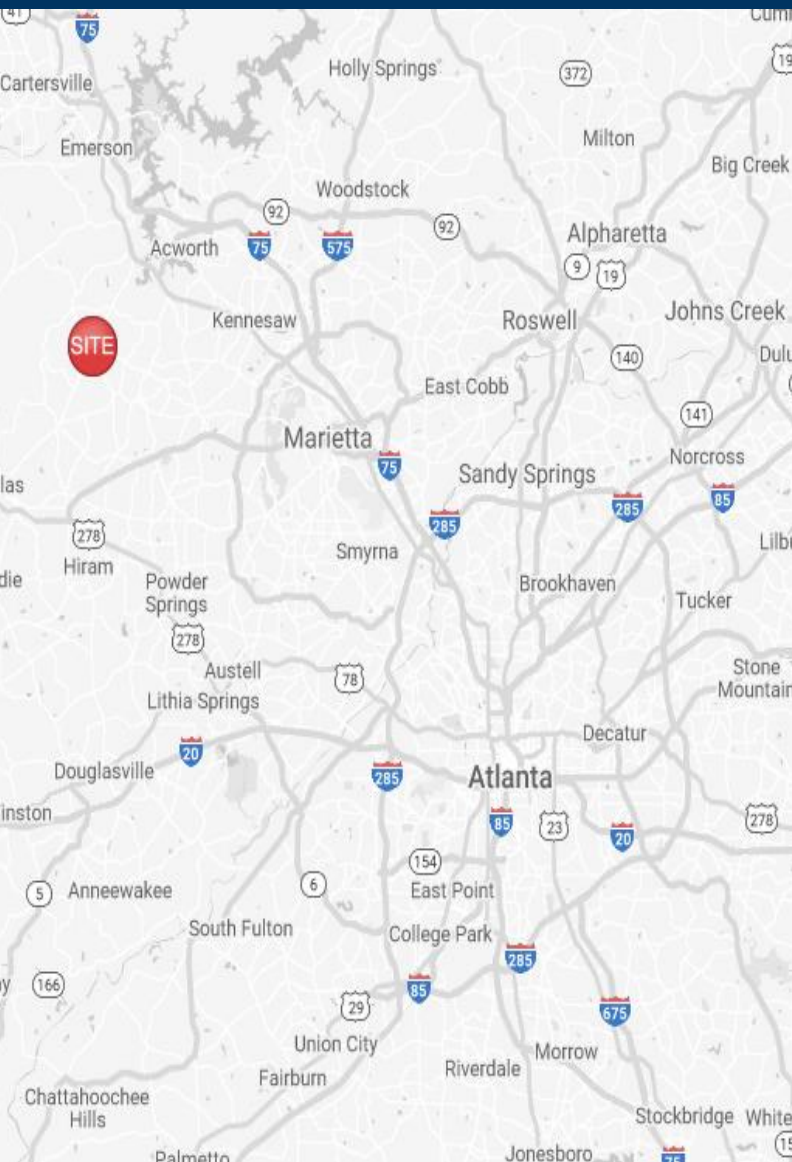

Leasing Contacts

Marrissa Chanin
678-501-5341
Marrissa@riverwoodproperties.com

Allie Hodge
678-501-5342
ahodge@riverwoodproperties.com

Property Highlights

This 8,400 square foot development is located directly across the street from Crossroads Pointe-Kroger. This center offers great visibility on Acworth-Dallas Highway (HWY 92) and Cedarcrest road. The ample parking within the center makes this a desirable location for quality restaurant and retail tenants. This growing intersection, located in Paulding County, features many national tenants including Starbucks, McDonald's, Kroger and many others.

Site Access: Property is accessible at the intersection of Highway 92 and Cedarcrest Rd.

riverwoodproperties.com

Cedarcrest Corner TENANTS

1	Arby's	2,223
2	Pet Supermarket	7,050
3	Moe's	2,175

GLA: 11,448 SF

Availability:
100% Leased

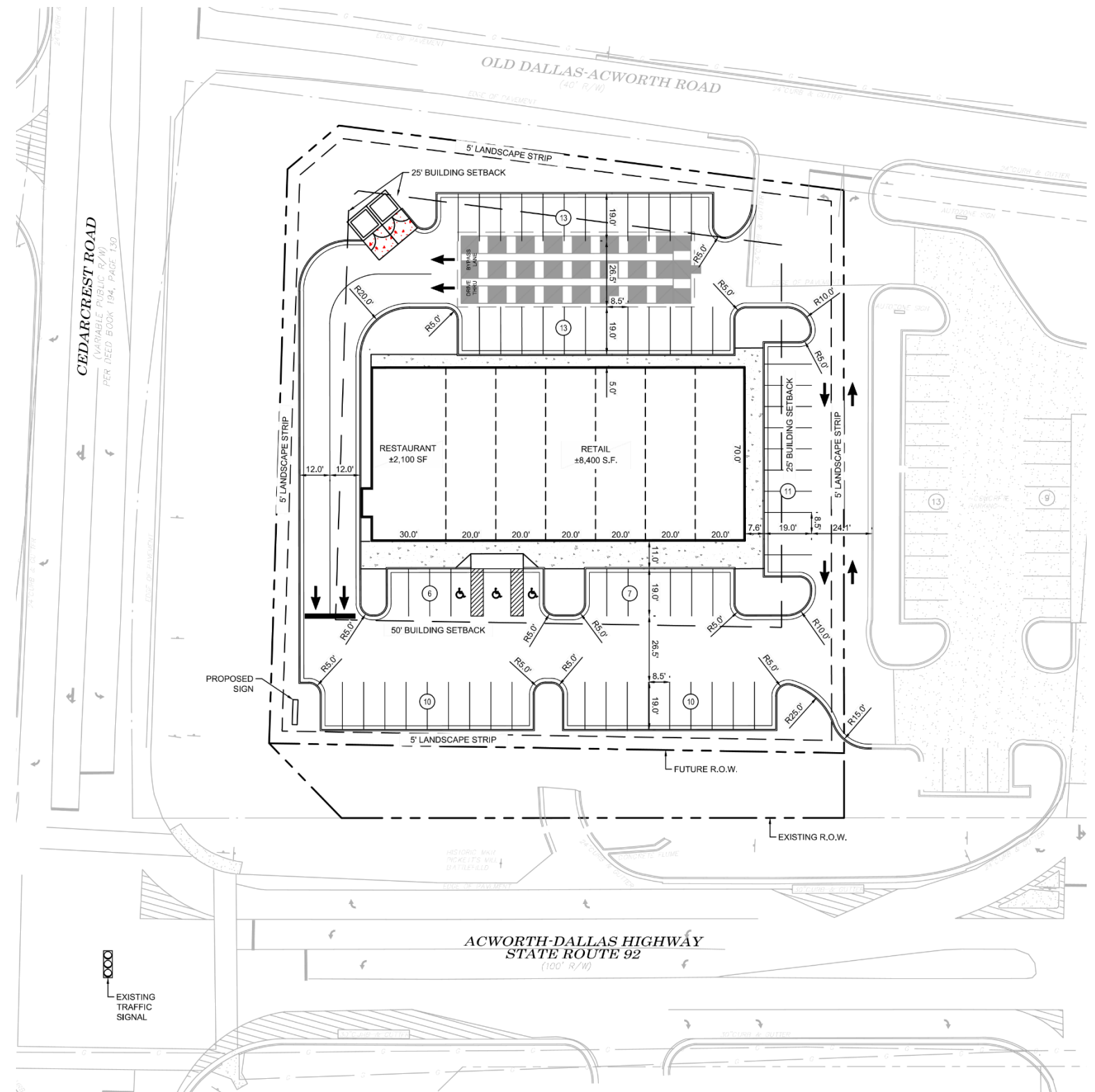

CEDARCREST CORNER

Site Plan

RIVERWOOD
PROPERTIES, LLC

AREA DEMOGRAPHICS



2021
Population

1 MILE	3,559
3 MILE	44,685
5 MILE	85,998



2021 Daytime
Population

1 MILE	611
3 MILE	5,698
5 MILE	13,763



Household 2021

1 MILE	1,170
3 MILE	14,354
5 MILE	28,058



Household
Income

1 MILE	\$90,621
3 MILE	\$111,245
5 MILE	\$120,322

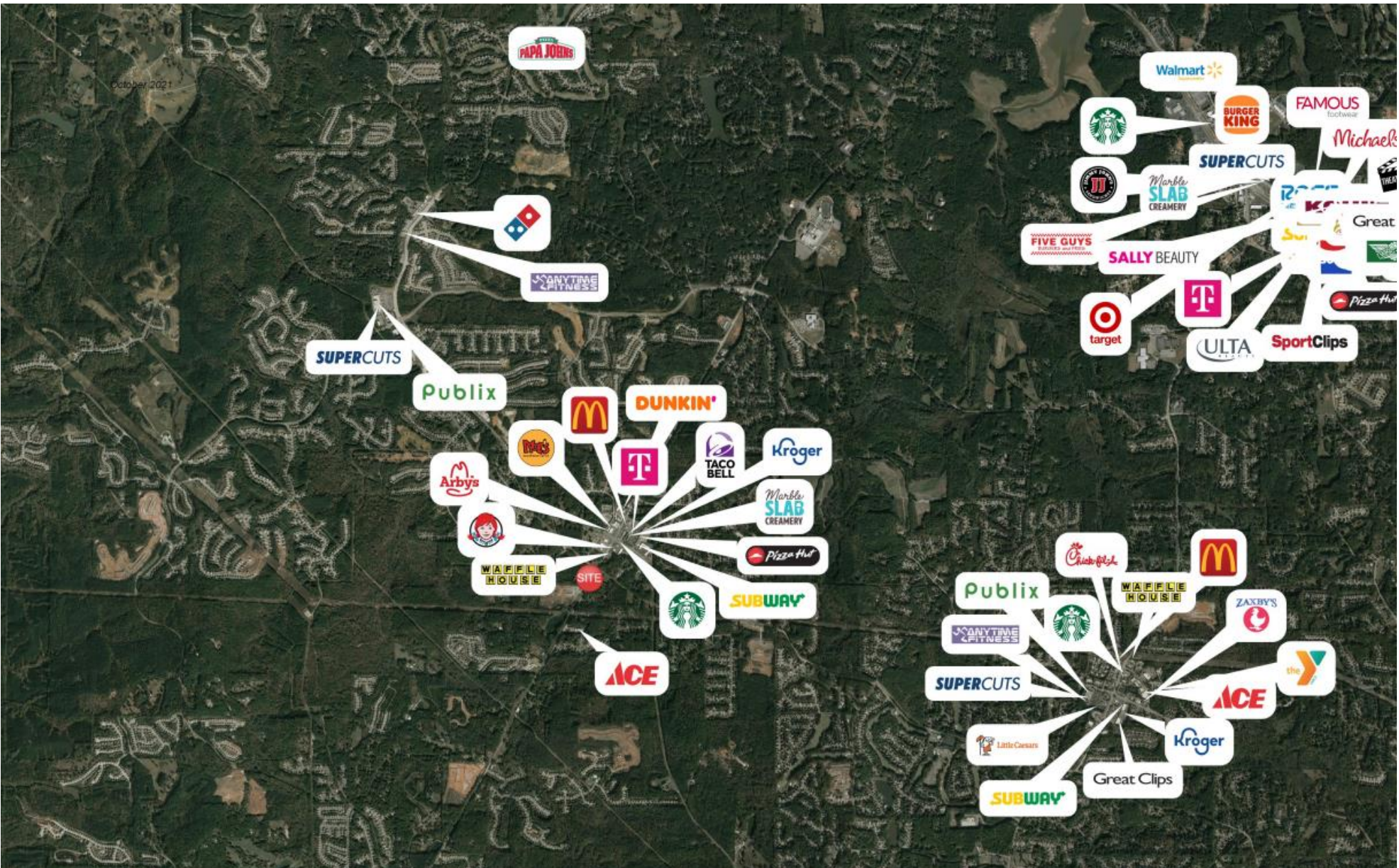

CEDARCREST CORNER

Trade Area Overview