

Cherrydale Center

3281 North Pleasantburg Drive
Greenville, South Carolina 29609



Leasing Contacts

Marrissa Chanin
678-501-5341
Marrissa@riverwoodproperties.com

Ron Chanin
678-501-5340
Ron@riverwoodproperties.com

Property Highlights

Cherrydale Center is a 5,400 SF center which boasts excellent visibility at the main intersection of North Pleasantburg Drive and Pointsett Highway which is located in the heart of Greenville's main retail corridor. Other major uses in the area include Ingles, Lowe's, Regal Cinemas, and many more.

Site Access: Property is accessible via traffic light at Paris Mountain Road and North Pleasantburg Drive.

Cherrydale Center

TENANTS

101 Mattress Firm 2,700

102 Five Guys Burgers & Fries 2,700

GLA: 5,400 SF

Availability:
100% Leased

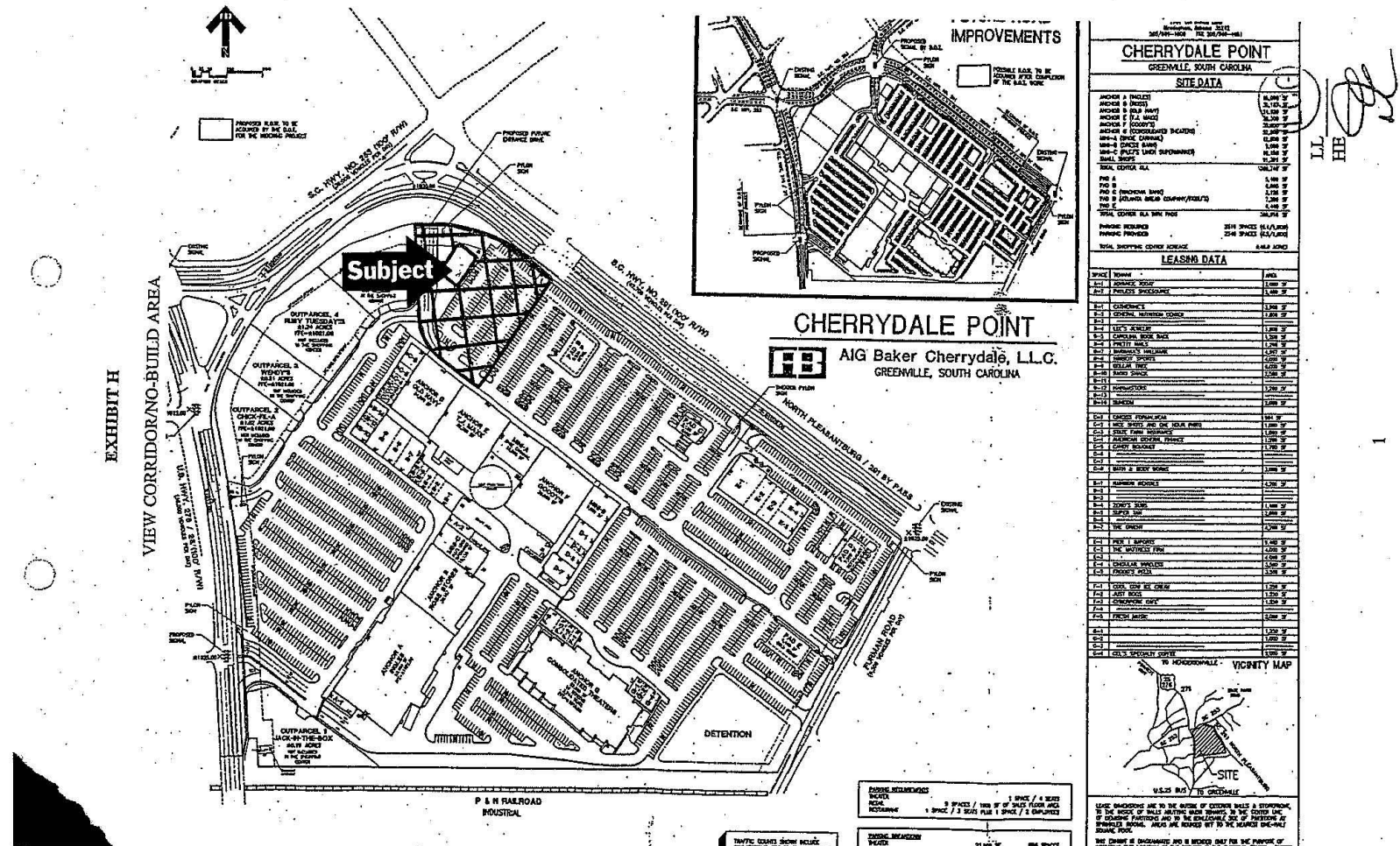

CHERRYDALE CENTER

Site Plan

AREA DEMOGRAPHICS



2021
Population

1 MILE	6,610
3 MILE	58,460
5 MILE	144,895



2021 Daytime
Population

1 MILE	3,325
3 MILE	35,345
5 MILE	85,138



Household 2021

1 MILE	2,864
3 MILE	23,873
5 MILE	61,173



Household
Income

1 MILE	\$72,347
3 MILE	\$74,839
5 MILE	\$78,947

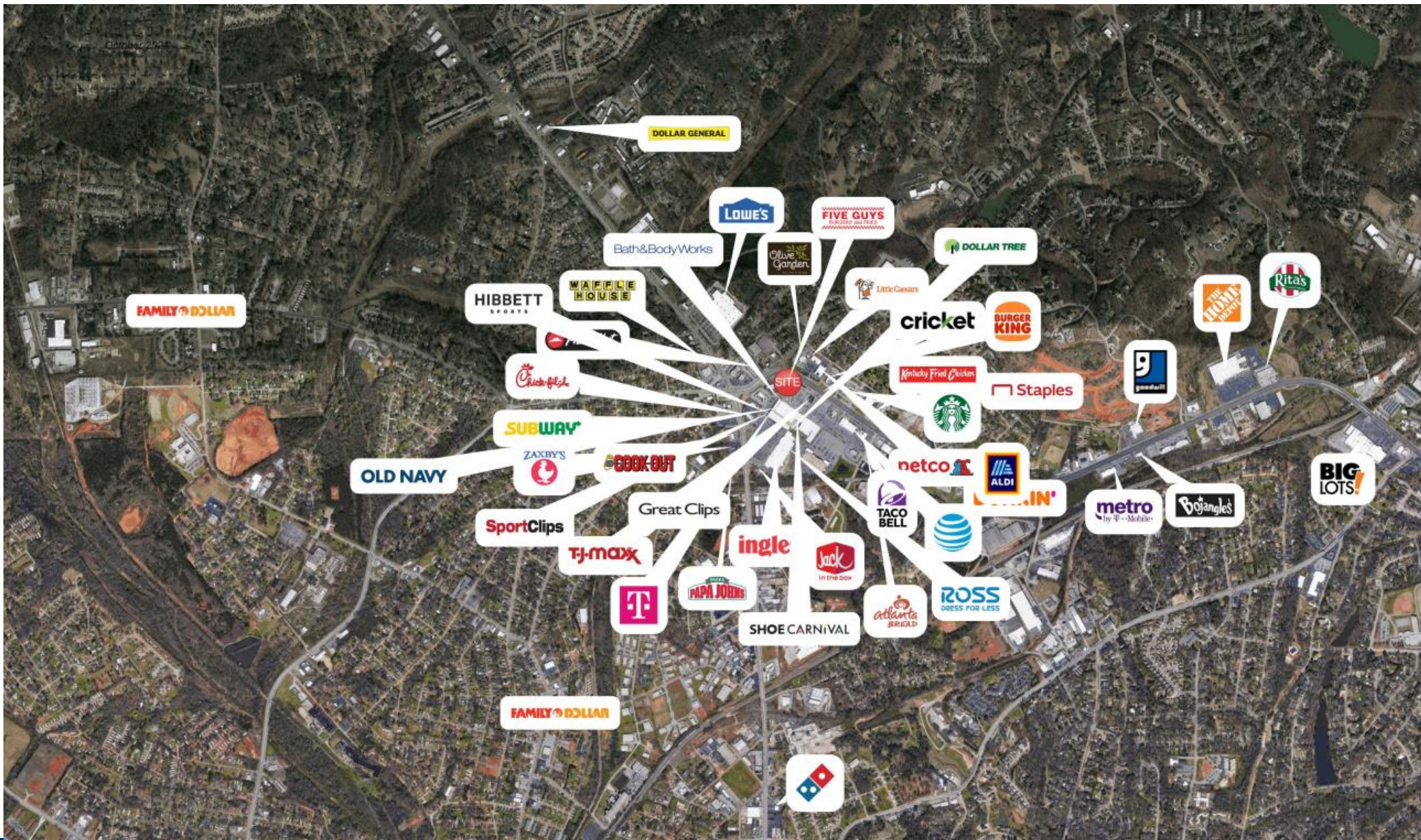

CHERRYDALE CENTER

Trade Area Overview