

Johns Creek Promenade

11250 Medlock Bridge Rd
Johns Creek, Georgia 30097

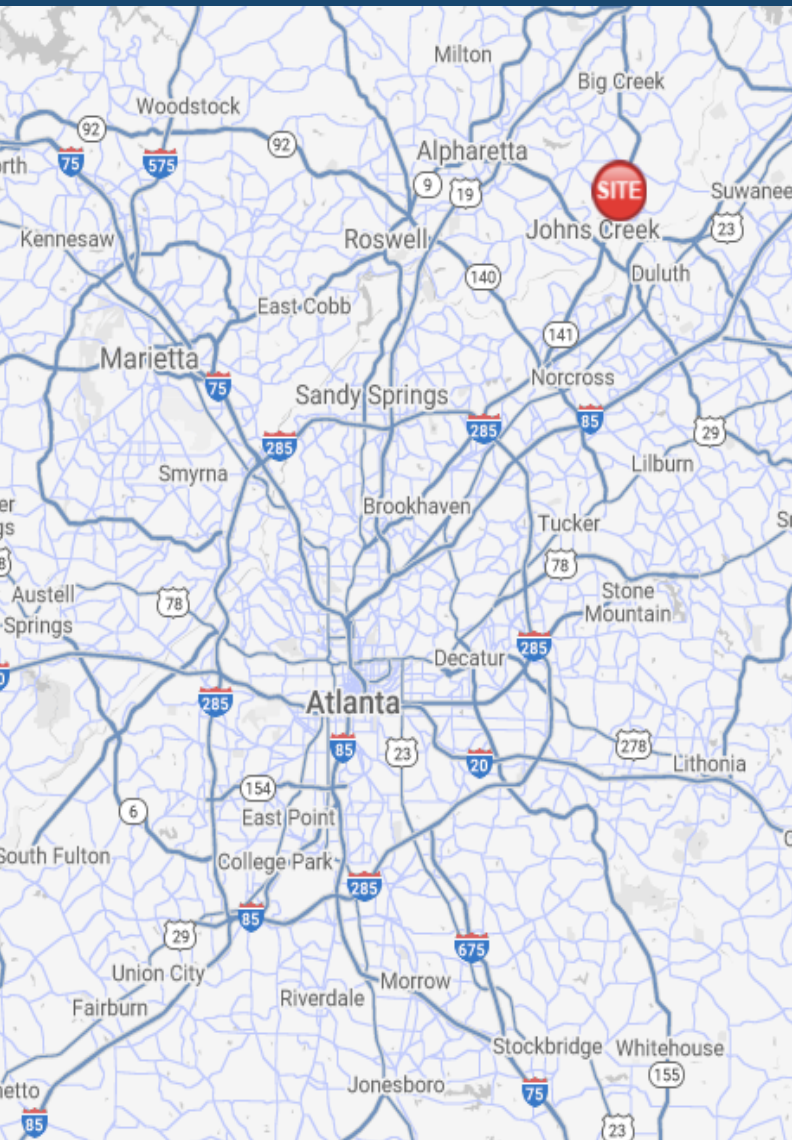

RIVERWOOD
PROPERTIES, LLC

Leasing Contacts

Marrissa Chanin

678-501-5341

Marrissa@riverwoodproperties.com

Allie Hodge

678-501-5342

Ahodge@riverwoodproperties.com

Johns Creek Promenade is located on Medlock Bridge Road (GA 141) with daily traffic counts over 45,000 vehicles. This 24,400 square foot retail shopping center is part of Johns Creek Walk Phase II. Johns Creek Walk consists of multi-family units, a senior living community, private residences, senior living apartments, and professional offices/retail. The retail shopping center is conveniently located at the intersection of Medlock Bridge and Johns Creek Parkway. Johns Creek Parkway is the home of several Fortune 500 companies within the Technology Park business district.

Johns Creek Promenade

100	Dunkin Donuts	2,100
150	GAO Vietnamese Cuisine	2,940
200	Moe's Southwest Grill	2,560
210	Papa John's	1,280
220	The Original Mattress Factory	2,760
240	Woof Gang	1,360
250	Nails	1,360
300	It's About Time	1,360
310	Salon Lofts	4,080
340	Jersey Mikes	1,600
350	B.B.Q Chicken	3,000
GLA: 24,400 SF		
Availability:		100 % leased

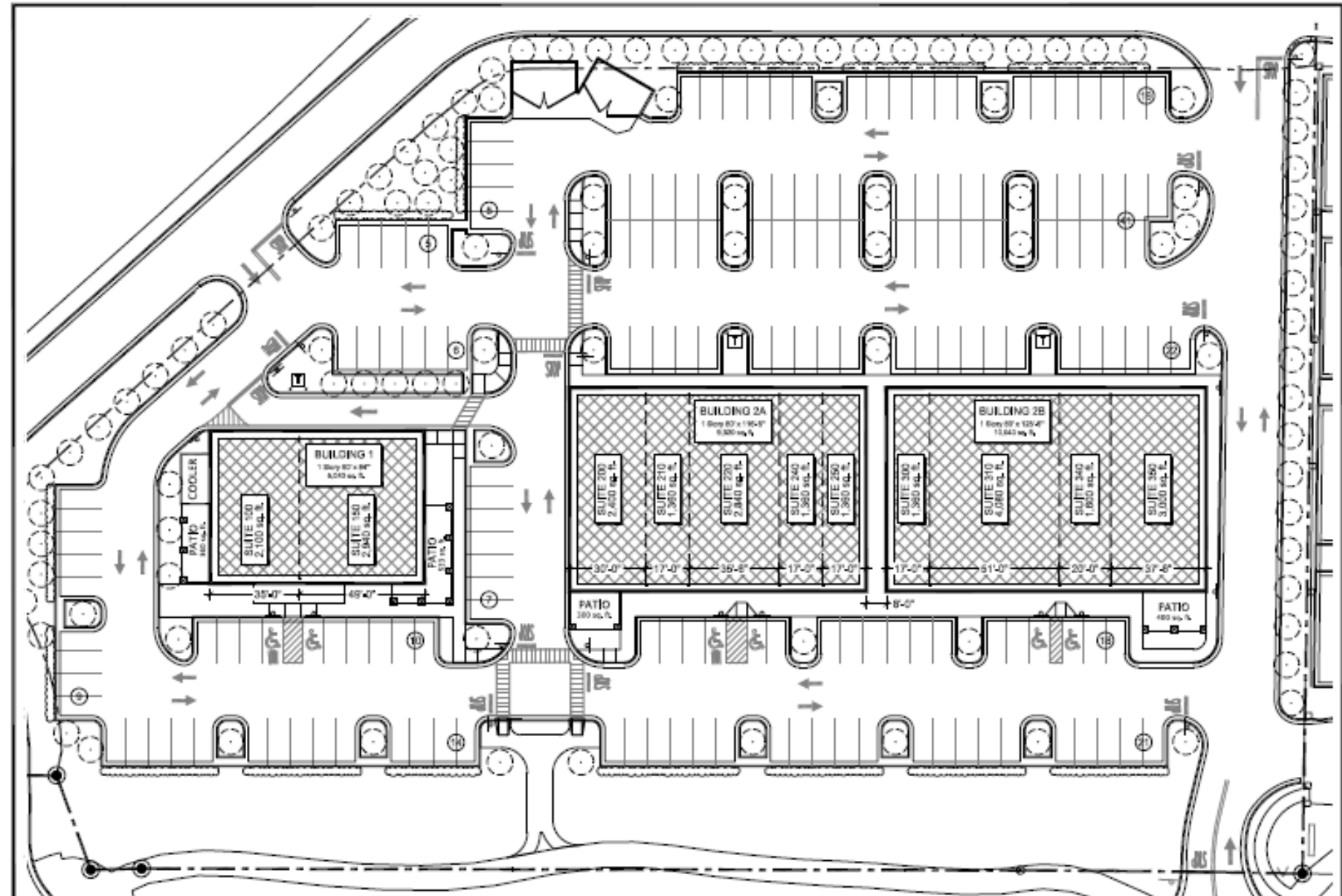

JOHNS CREEK PROMENADE *Site Plan*

AREA DEMOGRAPHICS



2022
Population

1 MILE	12,111
3 MILE	77,992
5 MILE	197,692



2022 Daytime
Population

1 MILE	9,258
3 MILE	34,739
5 MILE	101,321



Household 2022

1 MILE	4,026
3 MILE	25,449
5 MILE	66,850



Household
Income

1 MILE	\$144,357
3 MILE	\$167,391
5 MILE	\$165,415



JOHNS CREEK PROMENADE

Trade Area Overview